

COMPAQ

First Edition (July 1998)
Part Number 332682-021
Compaq Computer Corporation

Flat Panel Monitor Rackmount (TFT450R) Rack Option Kit

Installation Card

*Open Card Completely Before
Beginning Installation Procedures*

RECYCLE SYMBOL

NOTICE

The information in this publication is subject to change without notice.

COMPAQ COMPUTER CORPORATION SHALL NOT BE LIABLE FOR TECHNICAL OR EDITORIAL ERRORS OR OMISSIONS CONTAINED HEREIN, NOR FOR INCIDENTAL OR CONSEQUENTIAL DAMAGES RESULTING FROM THE FURNISHING, PERFORMANCE, OR USE OF THIS MATERIAL. THIS INFORMATION IS PROVIDED "AS IS" AND COMPAQ COMPUTER CORPORATION DISCLAIMS ANY WARRANTIES, EXPRESS, IMPLIED OR STATUTORY AND EXPRESSLY DISCLAIMS THE IMPLIED WARRANTIES OF MERCHANTABILITY, FITNESS FOR PARTICULAR PURPOSE, GOOD TITLE AND AGAINST INFRINGEMENT.

This publication contains information protected by copyright. No part of this publication may be photocopied or reproduced in any form without prior written consent from Compaq Computer Corporation.

© 1998 Compaq Computer Corporation
All rights reserved. Printed in the U.S.A.

Compaq, Registered U.S. Patent and Trademark Office.

Flat Panel Monitor Rackmount (TFT450R) RACK OPTION KIT

About This Device

The Flat Panel Monitor Rackmount (TFT450R) is a convenient rackmount system for easy monitor storage and access. Use the fixed position mounting bracket to affix the monitor to the front of your rack for constant access.

The retractable tray assembly occupies 2Us of Compaq rack space and can be used with all Compaq Rack Series products. The fixed mounting bracket assembly occupies 8Us of Compaq rack space and can be used with all Compaq Rack Series products.

Kit Contents

- Compaq TFT450 Flat Panel Monitor with plastic frame, retractable tray, and slide rails attached
- Rail mounting brackets (2)
- Cable management arm with hardware
- Latch Bracket
- Fixed mounting bracket
- Fixed monitor faceplate
- Rack template cards (2)
- M6 screws (8)
- AC Adapter
- AC Power cord
- Cable management arm fasteners
- Compaq TFT450 Flat Panel Monitor Users Guide

You will also need 6 cage nuts (supplied with your Compaq rack).

Rack Considerations

Before beginning these procedures, make sure you understand and adhere to the following precautions.



WARNING: To reduce the risk of personal injury or damage to the equipment, be sure that:

- The leveling jacks are extended to the floor.
- The full weight of the rack rests on the leveling jacks.
- The stabilizing feet are attached to the rack if it is a single rack installation.
- The racks are coupled together in multiple rack installations.
- Only one component is extended at a time. (A rack may become unstable if more than one component is extended for any reason).



■ **WARNING:** To reduce the risk of personal injury or damage to the equipment, refer to the Compaq TFT450 Flat Panel Monitor User's Guide included in this kit and observe the appropriate safety precautions and installation instructions.

Using the Retractable Tray

The TFT450R retractable tray attaches to the mounting brackets with sliding rails to allow storage and easy access of the monitor.

Step 1

From the printed report generated by the Rack Builder software, determine the best rack position for the TFT450R retractable tray. Use the 2U template to mark the attachment points for the mounting brackets and cage nuts on the front and rear of the rack frame.

Be sure to mark the rack at the top of the template to help align the next component.

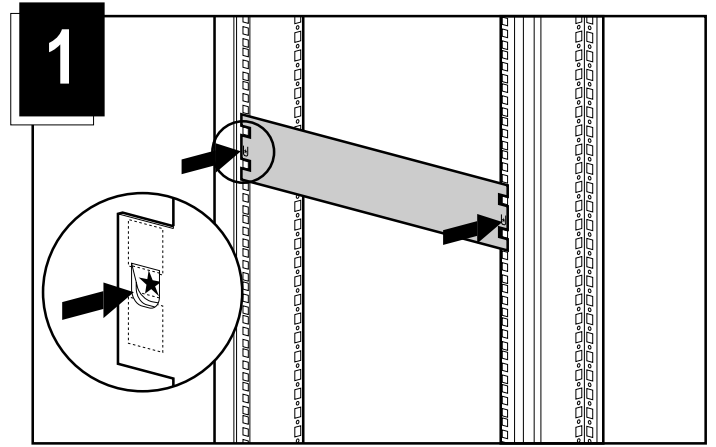

Step 2

- 1 Insert cage nuts on the rear of the rack in each of the holes marked using the template.
- 2 Insert a rail mounting bracket into the rack and hook the tabs into the appropriate holes in the rear of the rack, aligning the screw holes at the front of the rack.

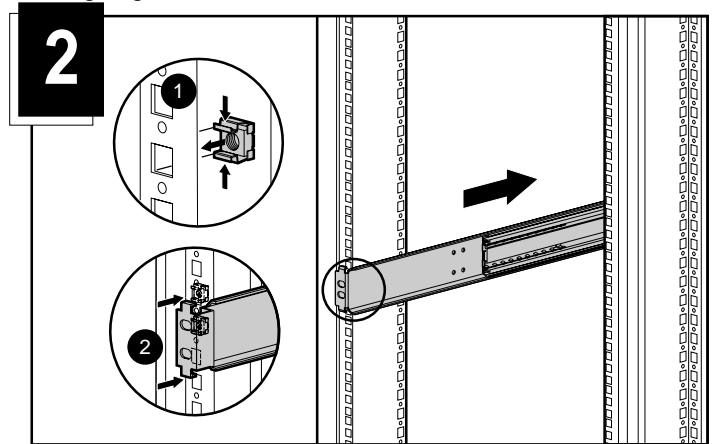

Step 3

Attach the mounting bracket to the front of the rack using two M6 screws. The tabs on the front of the mounting bracket help to align it with the front of the rack frame.

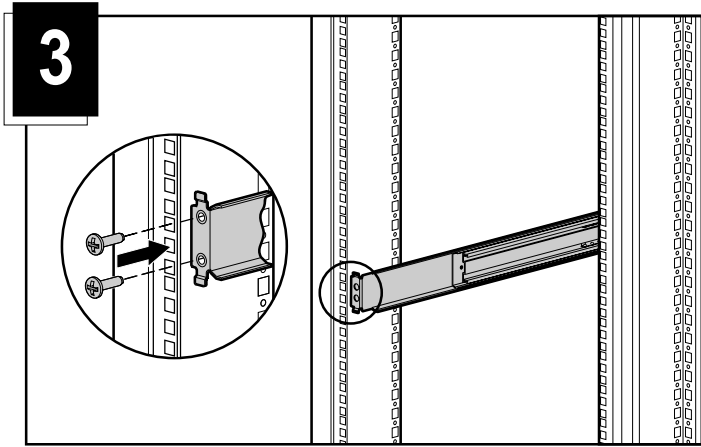

Step 4

Attach the Latch Bracket to each mounting bracket with the latch receptacle (located in the center of the latch bracket) facing the front of the rack.

- ❶ Slide the bracket over the lower guide tab, then align the thumbscrew with the lower hole of each rail and push in.
- ❷ Turn to tighten.

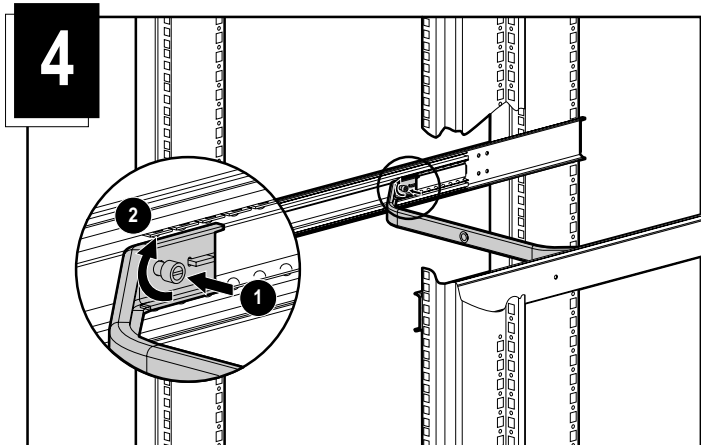

Step 5



CAUTION: To reduce the risk of damage to the monitor, be sure that it remains stable at all times.

Place the retractable tray assembly on the edge of a flat surface, then tilt the monitor up. Check to be sure that the monitor power cord and monitor signal cable are properly seated in the plastic guides on the rear of the monitor. Remove the plastic strip from the tape and affix to the AC Adapter, then secure the AC Adapter to the tray.

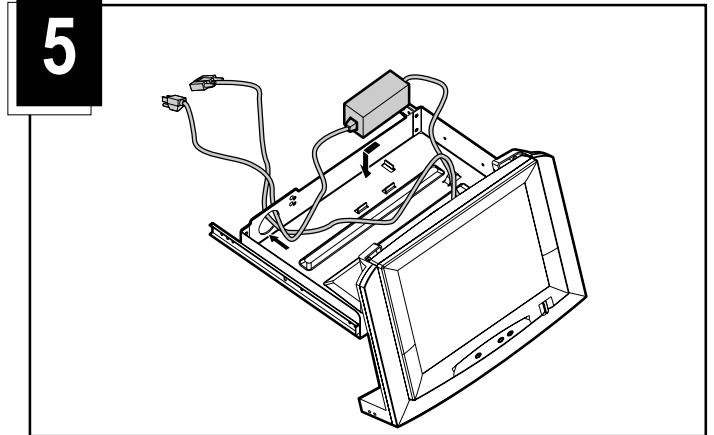

Secure the cord and cable under the tabs in the bottom of the tray. Attach the AC power cord to the AC Adapter. Thread the monitor signal cable and AC power cord through the hole in the rear of the tray. Set the cables back into the tray and tilt the monitor down to its flush position.

Step 6

Fully extend the slide rails on the retractable tray assembly, then align. Slide the tray assembly in until it locks into place.

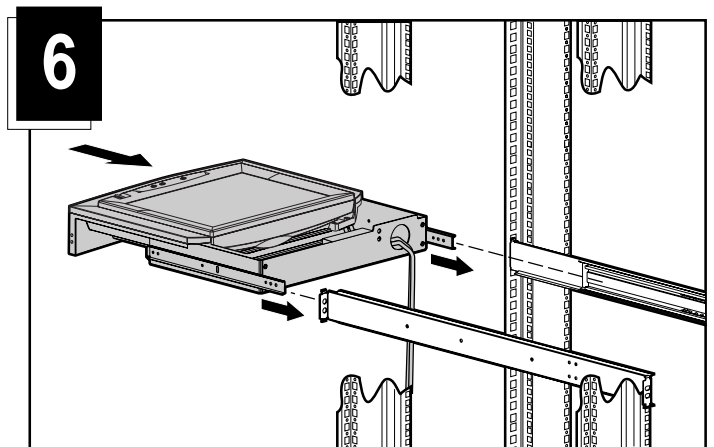

Step 7

The cable management arm attaches to the rear of the tray on the right side. From the rear of the rack:

- ❶ Line up the thumbscrews in the cable management arm with the holes in the retractable tray
- ❷ Push in on the thumbscrews.

- ③ Tighten the thumbscrews.

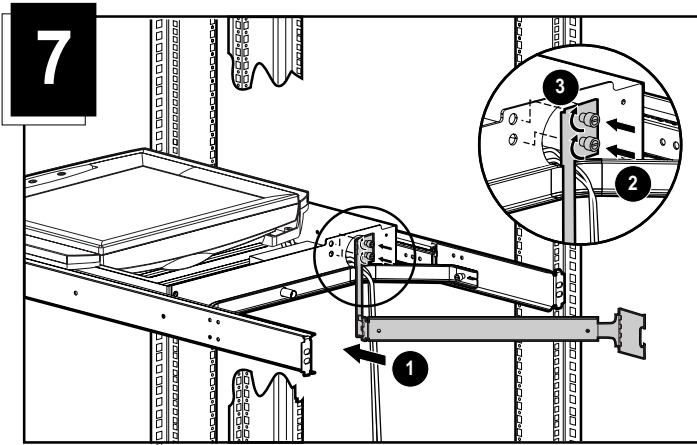

Step 8

- ① Align the cable management arm with the cage nuts previously installed in the rear of the rack.
- ② Attach using two M-6 screws.

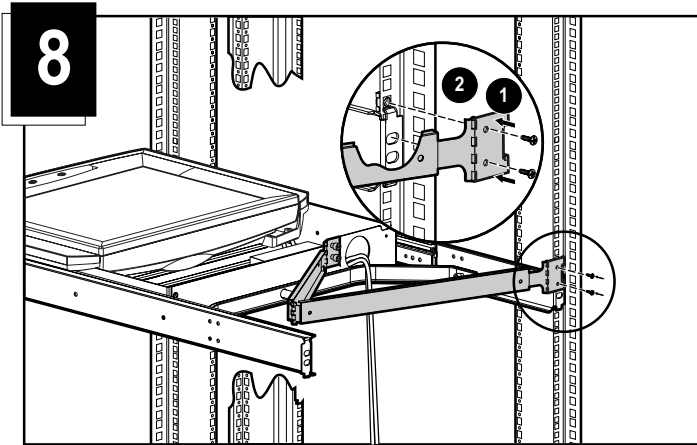

Route the cables along the cable management arm and secure using the 4 fasteners provided.

Using the Sliding Shelf

To store the monitor:

- ① Tilt it back so that it lays flat in the retractable tray.
- ② Slide the tray into the rack until the latch is engaged.

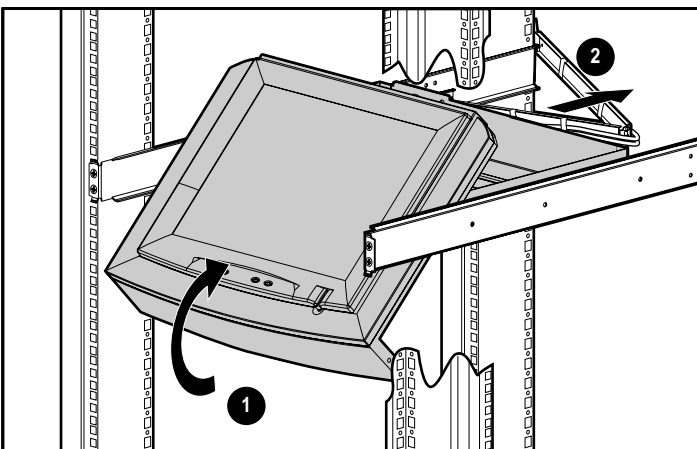

To access the monitor:

Push in the plastic frame to release. Pull out until the tray is fully extended.

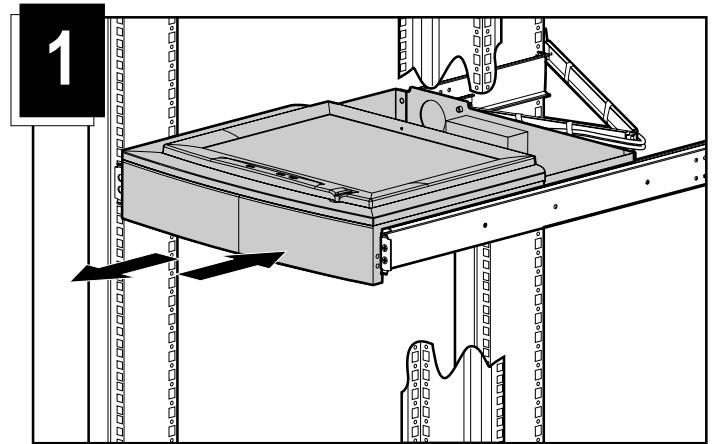

Tilt the monitor up to desired viewing angle.

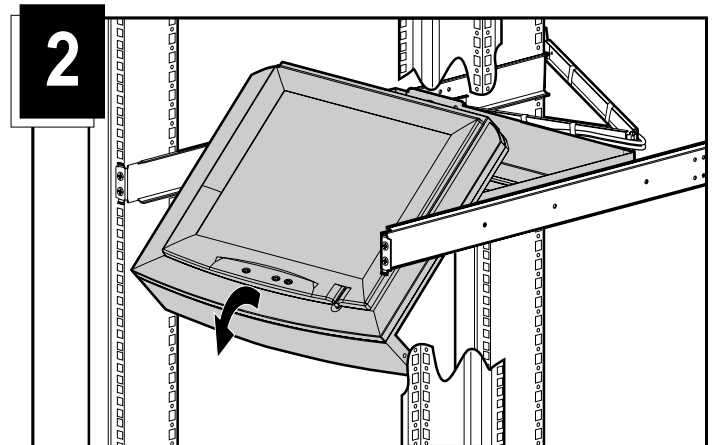

Removing the TFT450R

To remove the TFT450R from the rack:

1. Detach cables from the cable management arm.
2. Remove the cable management arm.
3. Fully extend the tray at the front of the rack and firmly hold the TFT450R while pushing in on the metal release levers on each of the mounting brackets.
4. Pull the tray straight out and remove.

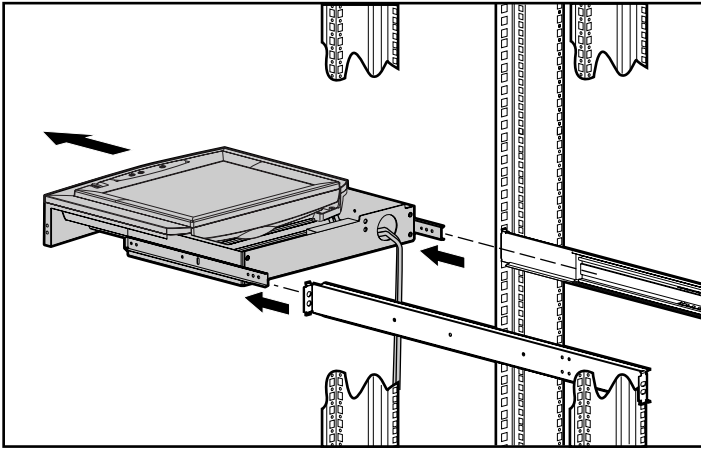

Using the Fixed Mounting Bracket

Step 1

From the printed report generated by the Rack Builder software, determine the best rack position for the fixed mounting bracket. Use the 8U template mark the attachment points for the mounting bracket.

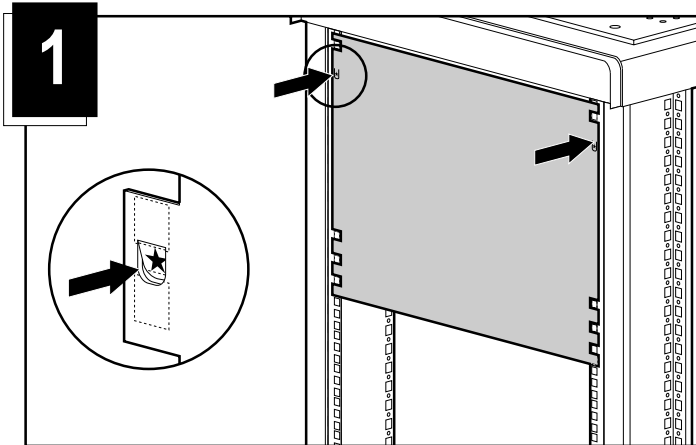

Insert all cage nuts.

Step 2

Turn the tray over and lay it on the edge of a flat, non-abrasive, unobstructed surface.



CAUTION: To reduce the risk of damage to the monitor, be sure that it remains stable at all times.

- ❶ Tilt the monitor out and remove the four screws securing the bracket to the monitor. Retain these screws for use in Step 4.
- ❷ Remove it from the tray.

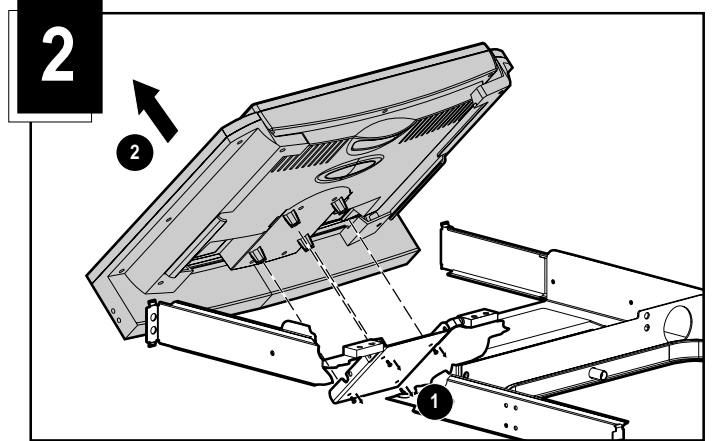

Step 3

Turn the monitor over and lay it on a flat, non-abrasive, unobstructed surface.

- ❶ Remove the four screws securing the plastic frame to the monitor.
- ❷ Remove the plastic frame.

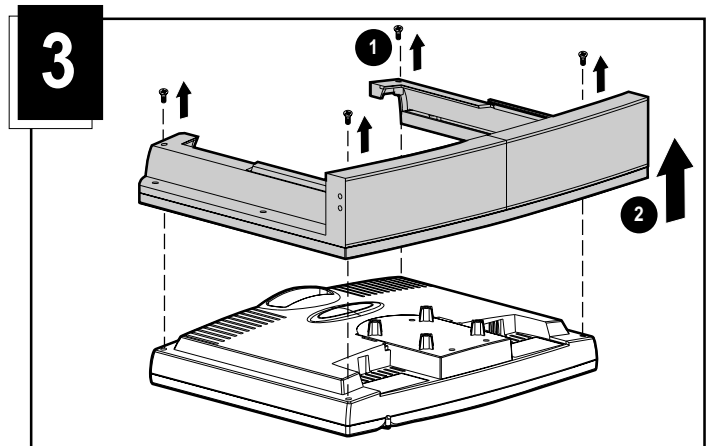

Step 4

Insert four screws (part number 125275-003) into the empty holes to secure the back of the monitor.



CAUTION: To reduce the risk of damage to the monitor, do not attempt to move it until these 4 screws are in place.

4

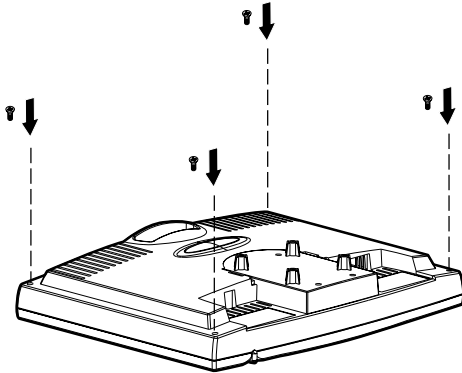

Step 5

Place the fixed bracket on top of the monitor and secure it with the four screws retained from Step 2. Be sure that the monitor signal cable and AC Power cord are plugged into the monitor.

5

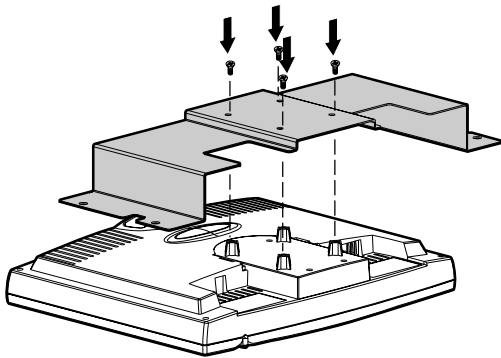

NOTE: There are finger holes on each side of the bracket to allow future access for unplugging of the monitor cables.

Step 6

Place the power supply tray onto the bracket on either side.

6

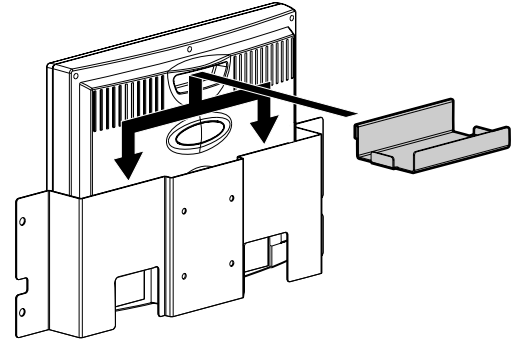

Step 7

- 1 Hold the monitor with bracket at a slight angle.
- 2 Move the monitor into the rack.
- 3 Pull the monitor forward and align the holes with the markings on the rack.
- 4 Secure with four M6 screws.

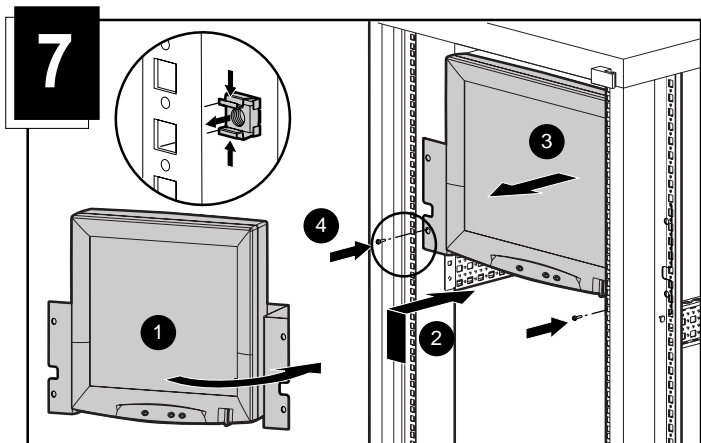

Place the AC adapter on the onto the power supply tray.

Step 8

Move the faceplate into position over the cage nuts and secure with four M6 screws.

